

M 1:10

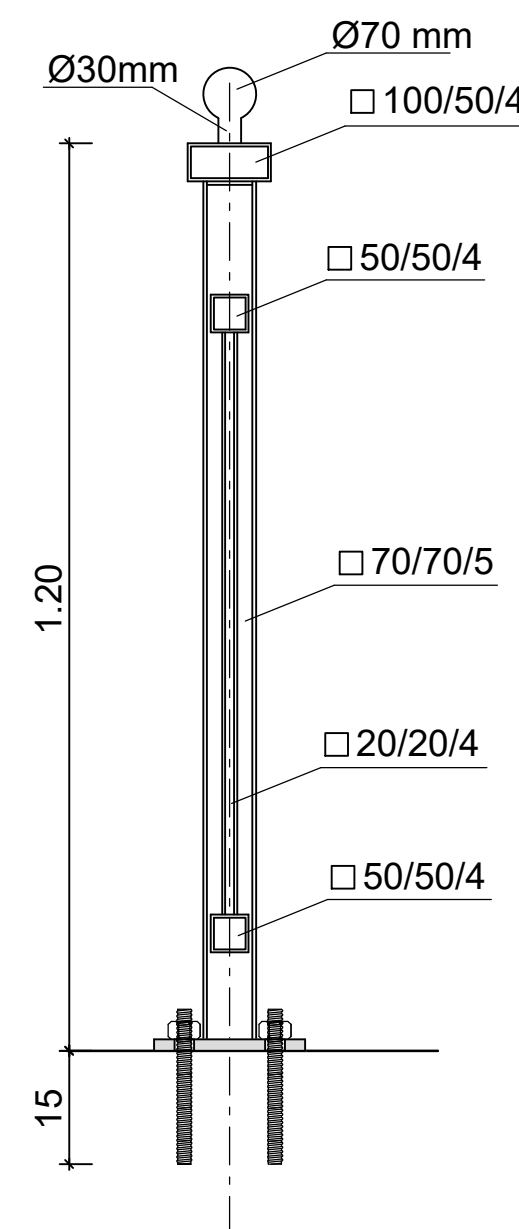

M. 1:10

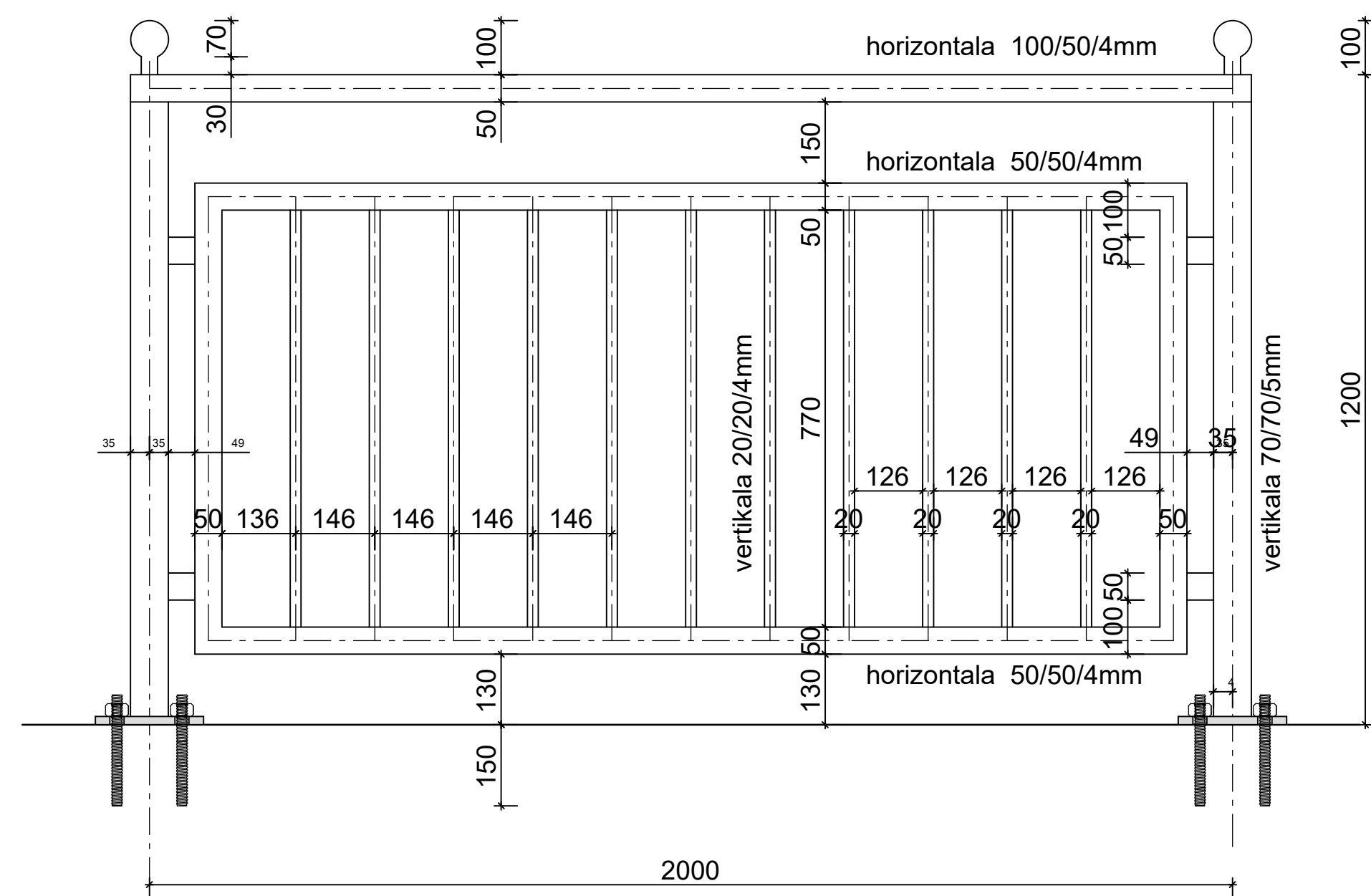

M. 1:5

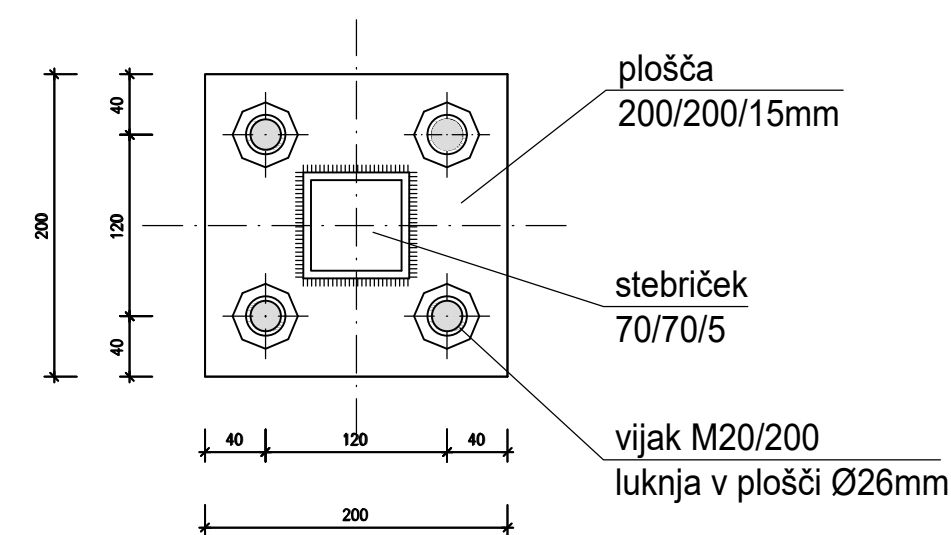

M. 1:5

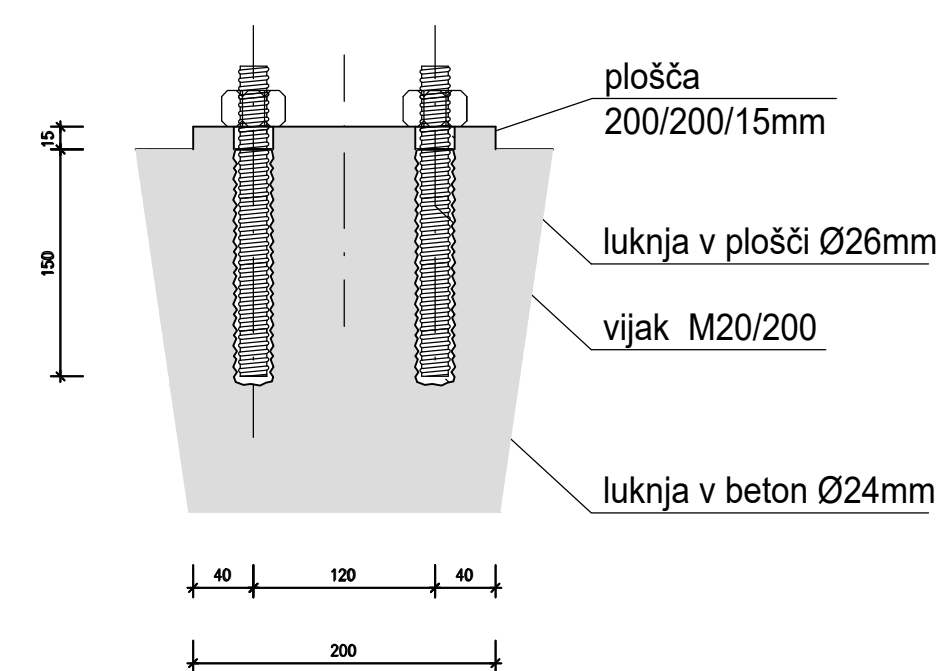

MOST ČEZ SAVINJO M:1:100

0.340% M. 1:20

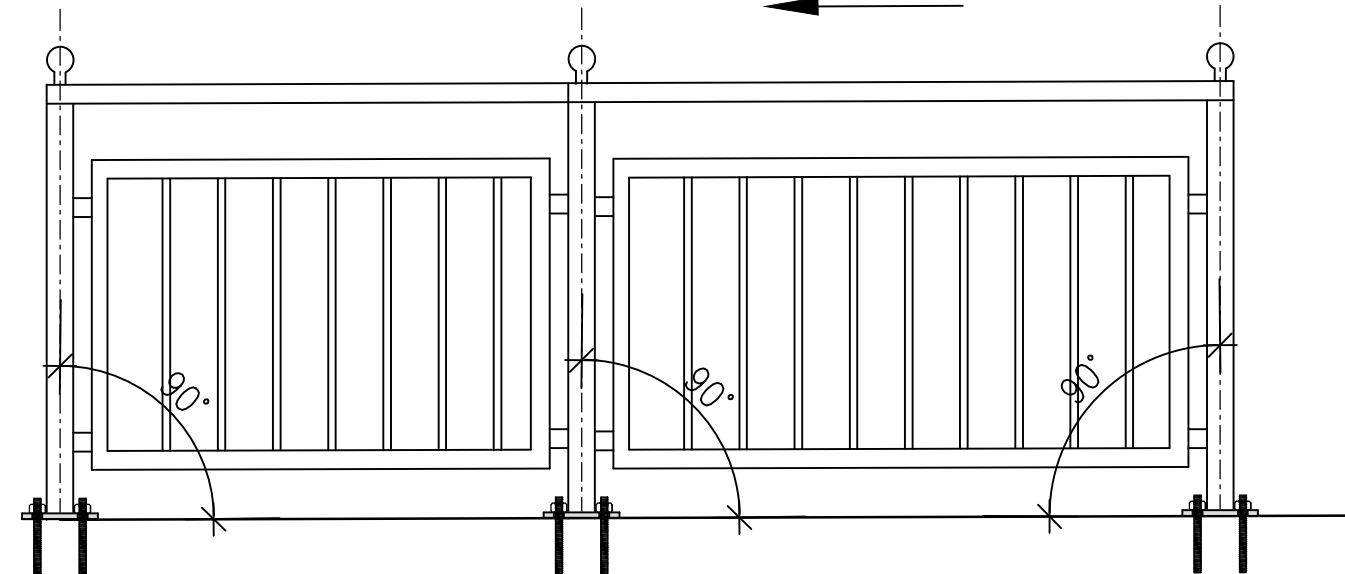

TLORIS ELEMENT 1

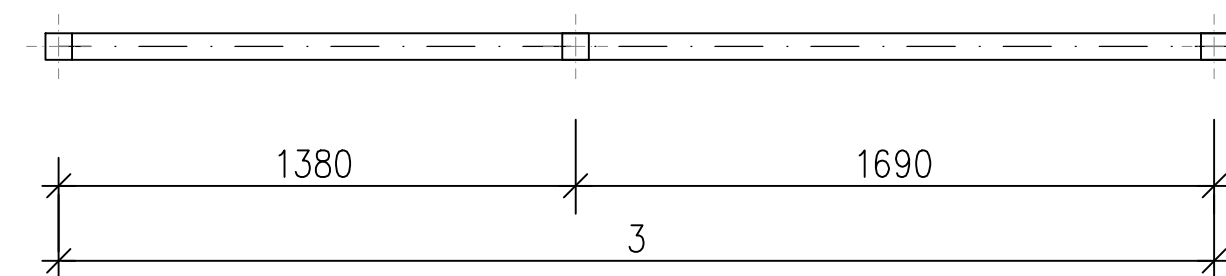

0.340% M. 1:20

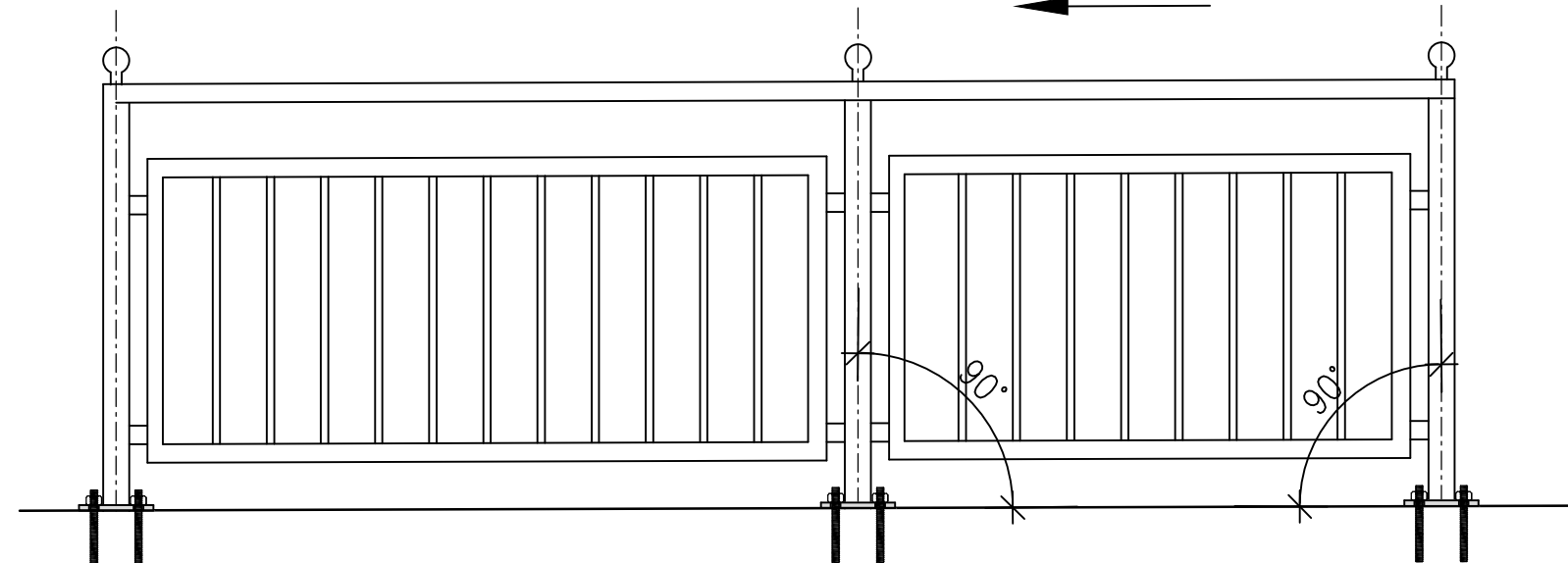

TLORIS ELEMENT 1

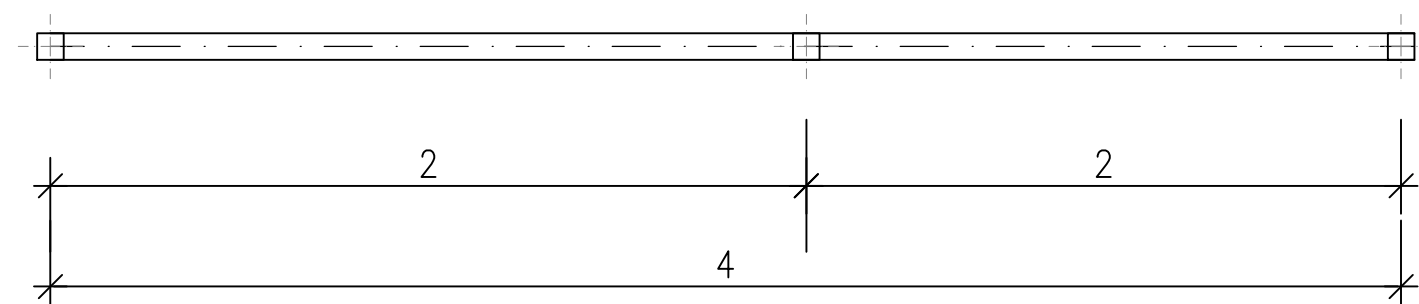

M. 1:20

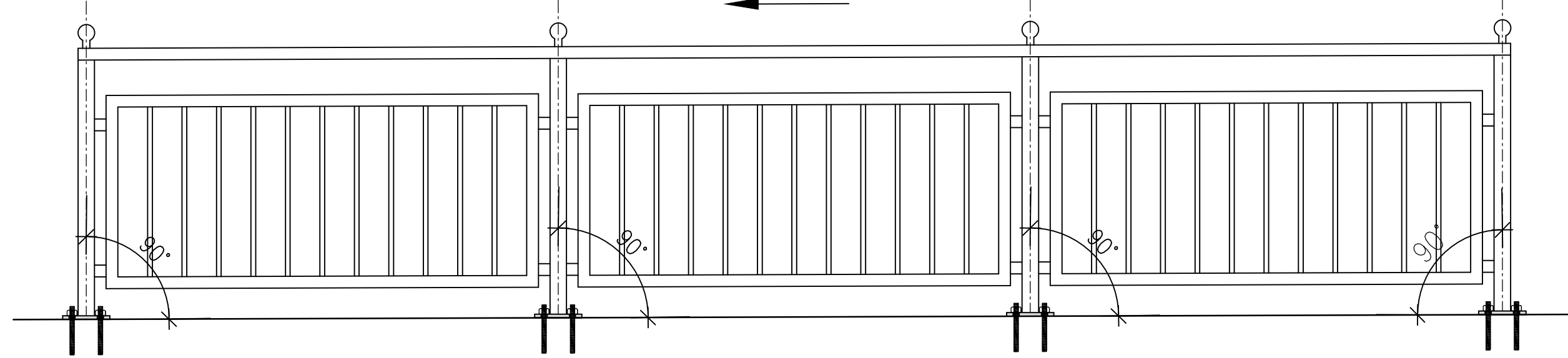

TLORIS ELEMENT 1

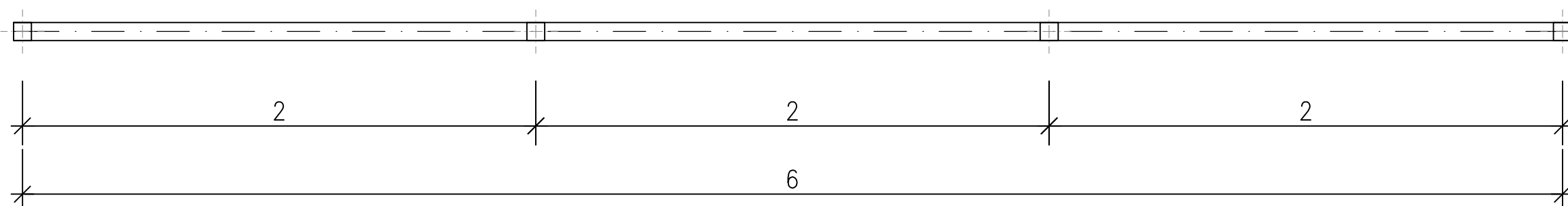

OPOMBA!

Elementi so vroče cinkani deb, predhodno abrazivno očiščeni, zvari so zbrušeni

- Stebričke in polnila je potrebno postaviti vertikalno!
- Horizontalne je potrebno postaviti v vzdolžnem padcu
- Vzdolžni padec je v radiju
- Pred izvedbo vse mere preveriti na licu mesta!